

LED RECESSED EMERGENCY DOWNLIGHT

FOR MODEL: LFLEDW1.5WNM



INTRODUCTION

The LED Recessed Emergency Downlight is discreet, easy to install and offers an effective low energy alternative to fluorescent emergency lighting.



SPECIFICATION



- Dimensions:
 Battery: L: 149 x Ø: 31mm
 Emergency Module: L: 230 x Ø: 31mm
 Light Head: Ø: 45 x D: 33mm
- LED: 1.5W SMD LED
- Working Temperature: 0°C - 40°C

BOX CONTENTS

- 1 x Battery
- 1 x Emergency Module
- 1 x Light Head

SAFETY WARNING

- The installation should be carried out by a qualified electrician in compliance with the current edition of the IEE Wiring Regulations.
- Prior to installation carry out the necessary risk assessment considering the people who could be at risk, the level of risk and the precautions required to control the risk.
- Ensure that the circuit supply is isolated either by the circuit supply fuse being removed or the applicable circuit breaker being turned off before installation or any maintenance.
- Check the total load on the circuit including the luminaire does not exceed the rating of the circuit cable, fuse or circuit breaker.
- If the fitting incorporates control gear, ensure careful sizing to avoid instances of nuisance tripping of the protective device used in the installation.
- Follow the provided installation instructions, using the fixings supplied or recommended.

LED RECESSED EMERGENCY DOWNLIGHT

FOR MODEL: LFLEDW1.5WNM



INSTALLATION DIAGRAMS

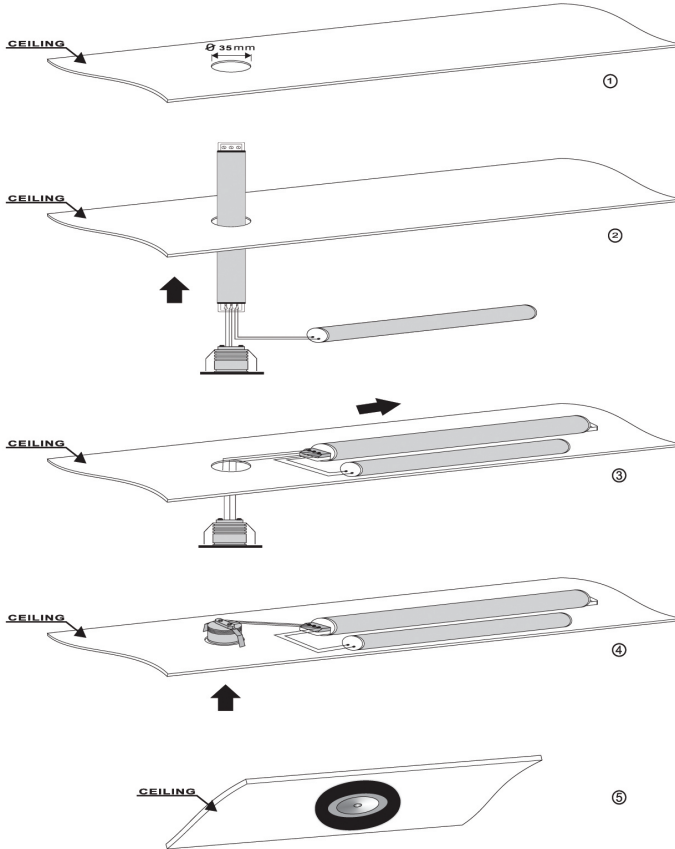

WIRING DIAGRAM

INPUT 220-240VAC
50/60 Hz

BATTERY
CONNECTING LINE

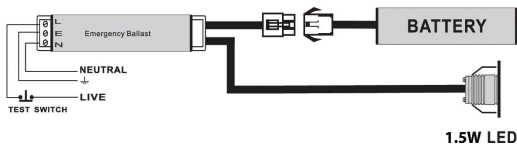

LED RECESSED EMERGENCY DOWNLIGHT

FOR MODEL: LFLEDW1.5WNM



TESTING

Product Type: Product Location:

MONTH	TEST	FIRST YEAR		SECOND YEAR		THIRD YEAR		FOURTH YEAR		FIFTH YEAR	
		Signed	Date	Signed	Date	Signed	Date	Signed	Date	Signed	Date
1	FUNCTIONAL										
2	FUNCTIONAL										
3	FUNCTIONAL										
4	FUNCTIONAL										
5	FUNCTIONAL										
6	FUNCTIONAL										
7	FUNCTIONAL										
8	FUNCTIONAL										
9	FUNCTIONAL										
10	FUNCTIONAL										
11	FUNCTIONAL										
12	FULL DURATION										

Installed By: Installation Date:

Contact Details:

LED RECESSED EMERGENCY DOWNLIGHT

FOR MODEL: LFLEDW1.5WNM



MAINTENANCE

- The unit is not meeting the required emergency duration: The fitting may need cycling. Discharge and then recharge for a full 24 hours. Retest the emergency duration. The battery may need replacing if the emergency duration is still not achieved.

ADDITIONAL INFORMATION

- 3.6V 2.0Ah Battery
- 24 Hours charging time
- Integral green LED indicator
- Three hours emergency duration
- White finish

GUARANTEE

This product is guaranteed for a period of 2 years from the date of purchase. The guarantee is invalid in the case of improper use, tampering, removal of the Q.C. date label, installation in an improper working environment or installation not according to the current edition of the I.E.E. Wiring Regulations (BS7671). The guarantee is also invalidated if the luminaire has been Mega tested. Should this product fail during the guarantee period it will be replaced free of charge, subject to correct installation and return of the faulty unit. We do not accept responsibility for any installation costs associated with the replacement of this product. Your statutory rights are not affected. We reserve the right to alter specifications without prior notice.

CE RoHS

